

plytech

Uncoated Plywood Panels for walls using mechanical fasteners

Purpose For the bonding of “Uncoated Plywood Panels” to *interior wall structures*. This specification is designed for the securing of the Plytech product **with mechanical fastenings**.

Wall types covered

1. Timber Framed/Battened
2. Steel Framed/Battened
3. ‘Previously’ Gypsum Lined



Option 1. Timber Framed Walls

Products Required

- [Gorilla Grip 1 Hour Cure](#) 310ml Cartridge #20075, or
 - [Gorilla Grip 2 Hour Cure](#) 310ml Cartridge #19290
- [Gorilla Solvent Cleaner](#) (for timber framing if required)
- Clean Cloths for application of Gorilla Solvent Cleaner
- [Mr Gorilla Wipes](#) # 46005

Installation Procedure

Step 1

Ensure that you read the Product Technical Documents before you begin. If at that point you have questions, please contact your local Soudal Territory Manager.

Step 2

Ensure that the walls that you are working with are straight and flat, use a straight edge for this. Where this is not so, there may be additional stresses on the bonded joints once applied.

Placement for walls:

1. All Frame/Battens - No greater than 600mm apart, 45mm wide
2. Negative detail 5mm or less – Follow attached line drawing
3. Timber Framing/Battens: - if creating a “negative detail greater than 5mm”, you need to double batten along all edges that will have the “negative detail” (as you will not have sufficient space for both the adhesive and tape).

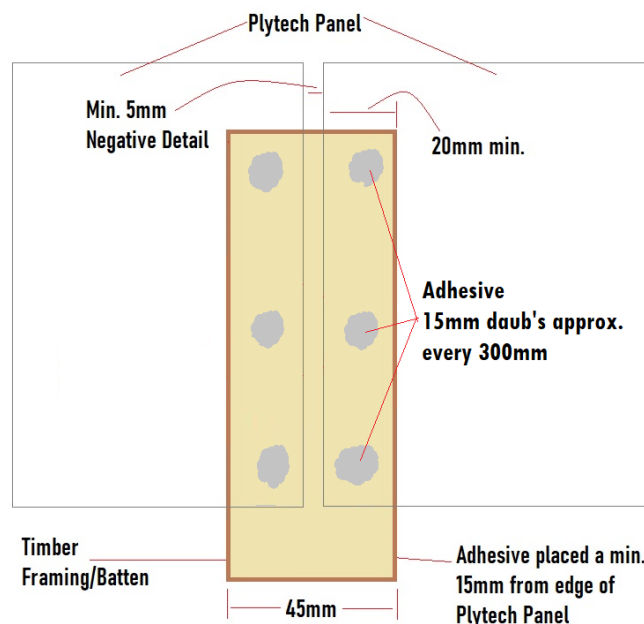

Step 3

Ensure that the “non-visual side” of the “**Plytech Plywood**” clean and dust free.

Step 4

Set H-Packers (or aluminum angle support) along the floor to set your predetermined height for the panel from the floor.

Step 5

Wipe down all framing with a damp cloth (as this assists the curing process of the adhesive). Use a fine mist water spray to the “reverse” of the Plytech Uncoated Panel.

Step 6

Adhesive positioning: Adhesive should be placed not closer than 15mm to the edge of the Plytech Panel. Use 15mm daub’s of Gorilla Grip Adhesive approx. 300mm apart. Soudal recommend that the adhesive is applied around the perimeter of the panel and through the center of the panel. It does not matter if you mechanically fix through the adhesive.

Note: As environmental conditions cool, curing times extend for adhesives & sealants.

Step 7

For a ‘**low profile**’ mechanical fix, 40mm panel pins may be used to provide support. We would recommend that these are positioned at the top of the panel (if the wall is 2400H, then you may choose to position these in a non-sight line). It generally only requires a 1-2 panel pins down each (long) side and 1-2 panel pins across the base.

Note: you may choose to use screws but not that this is not a ‘low profile option’

Step 8

You want to avoid on getting the adhesive (Gorilla Grip Adhesive) on the edges of the Interior Lining (as the grain finish will make it impossible to remove all residual traces of the adhesive from the edge).

The following points should be noted:

- *Lower temperatures will dramatically increase the time required for the adhesive to cure.* For further guidance on this please contact Soudal Technical.
- Preparation is critical to success

If you have any further questions, please do not hesitate to contact Soudal Ltd: Ph: 08008327732

Option 2. Steel Framed Walls

Products Required

- [Gorilla 240FC](#) White 600ml Sausage #20098
- [Holdfast Gator VHB Double Sided Foam Tape](#) 12mm x 2mm x 30m #56665
- [Gorilla Solvent Cleaner](#) (for ALL steel framing & back of prefinished plywood panels))
- Clean Cloths for application of cleaner
- [Mr Gorilla Wipes](#) # 46005

Installation Procedure

Step 1

Ensure that you read the Product Technical Documents before you begin. If at that point you have questions, please contact your local Soudal Territory Manager.

Step 2

Ensure that the walls that you are working with are straight and flat, use a straight edge for this. Where this is not so, there may be additional stresses on the bonded joints once applied.

Placement for walls:

1. All Framing - No greater than 600mm apart, 45mm wide
2. Negative detail 5mm or less – Follow attached line drawing
3. Steel Framing (Timber Battens):
- if creating a “negative detail greater than 5mm”, you need to double batten along all edges that will have the “negative detail” (as you will not have sufficient space for both the adhesive and tape).

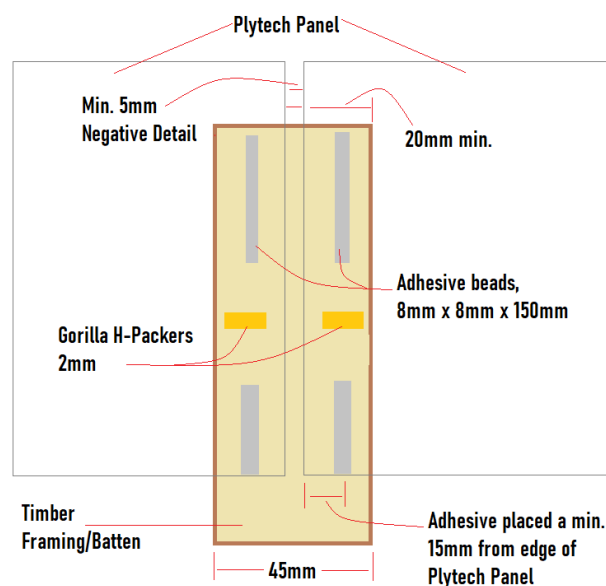

Step 3

Ensure that the “non-visual side” of the “**Plytech Plywood**” has had the surface wiped down with the Gorilla Solvent Cleaner (especially in the areas where the tape and adhesive will be applied), to remove any construction dusts that may have settled. Leave to dry for a period of 5-10 minutes (longer in colder conditions).

“**All Framing**” (Steel) - the Gorilla Solvent Cleaner needs to be wiped/applied along the full length of these to correspond with the adhesive that will be applied.

Leave to dry for a period of 5-10 minutes (longer in colder conditions).

Step 4

Set H-Packers (or aluminum angle support) along the floor to set your predetermined height for the panel from the floor.

Step 5

Adhesive positioning: Adhesive should be placed not closer than 15mm to the edge of the Plytech Panel. Use 8mm x 8mm x 150mmL beads of adhesive placed 400mm apart. Use Gorilla 2mm H-Packers (snapped off legs) to ensure that you have a min 2mm thickness of the compressed adhesive.

When the 7-8mm bead of adhesive is compressed to 2mm thick, it is now approx. 15mm wide.

Step 6

Set & press the plywood panel back into position against the wall. Ensure the panel is set back to the wall.

Note: As environmental conditions cool, curing times extend for adhesives & sealants.

Step 7

We recommend the use of countersunk screws for support. Depending on the design aspect you could use 2 screws top and bottom, with 2 on each long side.

Note: is utilizing architraves, you may choose to position these screws out of sight.

Step 8

You want to avoid on getting the adhesive (Gorilla Grip Adhesive) on the edges of the Interior Lining (as the grain finish will make it difficult to remove all residual traces of the adhesive from the edge).

The following points should be noted:

- *Lower temperatures will dramatically increase the time required for the adhesive to cure.*
For further guidance on this please contact Soudal Technical.
- Preparation is critical to success

If you have any further questions, please do not hesitate to contact Soudal Ltd: Ph: 08008327732

Option 3. Gypsum Lined Walls

Products Required

- [Gorilla 240FC](#) White 600ml Sausage #20098
- [Holdfast Gator VHB Double Sided Foam Tape](#) 12mm x 2mm x 30m #56665
- [Gorilla Solvent Cleaner](#) (for the back of prefinished plywood panels))
- Clean Cloths for application of cleaner
- [Mr Gorilla Wipes](#) # 46005

Installation Procedure

Step 1

Ensure that you read the Product Technical Documents before you begin. If at that point you have questions, please contact your local Soudal Territory Manager.

Step 2

Ensure that the walls that you are working with are straight and flat, use a straight edge for this. Where this is not so, there may be additional stresses on the bonded joints once applied.

Placement for walls:

1. All Tape/Adhesive Spacing - No greater than 450mm apart.

Step 3

It should be noted that all Gypsum walls are to have a full sealer coat over them to stabilise the surface.

If the Gypsum wall has been papered previously, then all paper and glue residues require complete removal. A sealer coat needs to be applied to all surfaces.

If the Gypsum wall has been painted previously, then all surfaces need to be checked to ensure that the paint remains bonded to the wall surface. The painted wall will require complete cleaning to ensure that there are no surface contaminants remaining.

Ensure that the “prefinished non-visual side” of the “**Plytech Plywood**” has had the surface wiped down with the Gorilla Solvent Cleaner (especially in the areas where the adhesive will be applied), to remove any construction dusts that may have settled. Leave to dry for a period of 5-10 minutes (longer in colder conditions).

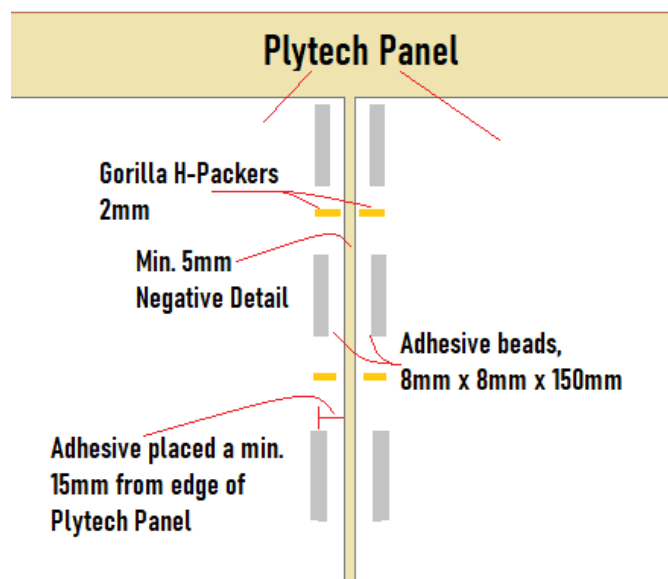

Step 4

Set H-Packers (or aluminum angle support) along the floor to set your predetermined height for the panel from the floor.

Step 5

Adhesive positioning: Adhesive should be placed not closer than 15mm to the edge of the Plytech Panel. Use 8mm x 8mm x 150mmL beads of adhesive placed 400mm apart. Use Gorilla 2mm H-Packers (snapped off legs) to ensure that you have a min 2mm thickness of the compressed adhesive.

When the 7-8mm bead of adhesive is compressed to 2mm thick, it is now approx. 15mm wide.

Step 6

Set & press the plywood panel back into position against the wall. Ensure the panel is set back to the wall.

Note: As environmental conditions cool, curing times extend for adhesives & sealants.

Step 7

For a '**low profile**' mechanical fix, 60mm panel pins may be used to provide support. We would recommend that these are positioned at the top of the panel (if the wall is 2400H, then you may choose to position these in a non-sight line). It generally only requires a 1-2 panel pins down each (long) side and 1-2 panel pins across the base.

Note: you may choose to use screws but not that this is not a 'low profile option'

Step 8

You want to avoid getting the adhesive (Gorilla 240FC) on the edges of the Interior Lining (as the grain finish will make it difficult to remove all residual traces of the adhesive from the edge).

The following points should be noted:

- *Lower temperatures will dramatically increase the time required for the adhesive to cure.*
For further guidance on this please contact Soudal Technical.
- Preparation is critical to success

If you have any further questions, please do not hesitate to contact Soudal Ltd: Ph: 08008327732