



Prefinished Plywood Panels for wall linings

Purpose For the bonding of “Prefinished Plywood Panels” to *interior wall structures*. This specification is designed for the securing of the Plytech product without the need for mechanical fastenings.

Wall types covered

1. Timber Framed
2. Steel Framed
3. ‘Previously’ Gypsum Lined



Option 1. Timber Framed Walls

Products Required

- [Gorilla 240FC](#) White 600ml Sausage #20098
- [Holdfast Gator VHB Double Sided Foam Tape](#) 12mm x 2mm x 30m #56665
- [Gorilla Solvent Cleaner](#) (for timber framing if required & back of prefinished plywood panels)
- Clean Cloths for application of cleaner
- [Mr Gorilla Wipes](#) # 46005

Installation Procedure

Step 1

Ensure that you read the Product Technical Documents before you begin. If at that point you have questions, please contact your local Soudal Territory Manager.

Step 2

Ensure that the walls that you are working with are straight and flat, use a straight edge for this. Where this is not so, there may be additional stresses on the bonded joints once applied.

Placement for walls:

1. All Frame/Battens - No greater than 600mm apart, 45mm wide
2. Negative detail 5mm or less – Follow attached line drawing
3. Timber Framing/Battens: - if creating a “negative detail greater than 5mm”, you need to double batten along all edges that will have the “negative detail” (as you will not have sufficient space for both the adhesive and tape).

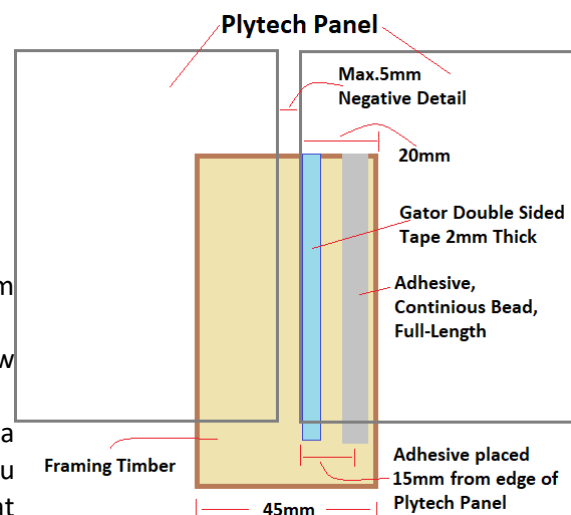

Step 3

Ensure that the “prefinished non-visual side” of the “**Plytech Plywood**” has had the surface wiped down with the Gorilla Solvent Cleaner (especially in the areas where the tape and adhesive will be applied), to remove any construction dusts that may have settled. Leave to dry for a period of 5-10 minutes (longer in colder conditions).

Step 4

Position the tape, full length onto the framing/battens to one side. This allows room for application of the adhesive (Gorilla 240FC) so that when compressed does not flow over the tape, reducing the potential initial hold of the tape (Gator VHB 2mm Double Sided Foam Tape).

Step 5

Set H-Packers (or aluminum angle support) along the floor to set your predetermined height for the panel from the floor.

Position 7-8mm continuous beads of adhesive the full height/length approx. 20-25mm from the applied tape. When the 7-8mm bead of adhesive is compressed to 2mm thick, it is now approx. 15mm wide.

Step 6

Set & press the plywood panel back into position against the wall. Ensure the panel is set back to the wall, (*the Double-Sided Tape provides the initial bond while the Gorilla 240FC provides the secondary bond*). As the adhesive cures the primary bond is taken by Gorilla 240FC.

Note: As environmental conditions cool, curing times extend for adhesives & sealants.

Step 7

You want to avoid getting the adhesive (Gorilla 240FC) on the edges of the Interior Lining (as the grain finish will make it difficult to remove all residual traces of the adhesive from the edge).

The following points should be noted:

- *Lower temperatures will dramatically increase the time required for the adhesive to cure.*
For further guidance on this please contact Soudal Technical.
- Preparation is critical to success

If you have any further questions, please do not hesitate to contact Soudal Ltd: Ph: 08008327732

Option 2. Steel Framed Walls

Products Required

- [Gorilla 240FC](#) White 600ml Sausage #20098
- [Holdfast Gator VHB Double Sided Foam Tape](#) 12mm x 2mm x 30m #56665
- [Gorilla Solvent Cleaner](#) (for **ALL** steel framing & back of prefinished plywood panels)
- Clean Cloths for application of cleaner
- [Mr Gorilla Wipes](#) # 46005

Installation Procedure

Step 1

Ensure that you read the Product Technical Documents before you begin. If at that point you have questions, please contact your local Soudal Territory Manager.

Step 2

Ensure that the walls that you are working with are straight and flat, use a straight edge for this. Where this is not so, there may be additional stresses on the bonded joints once applied.

Placement for walls:

1. All Framing - No greater than 600mm apart, 45mm wide
2. Negative detail 5mm or less – Follow attached line drawing
3. Steel Framing (Timber Battens):
- if creating a “negative detail greater than 5mm”, you need to double batten along all edges that will have the “negative detail” (as you will not have sufficient space for both the adhesive and tape).

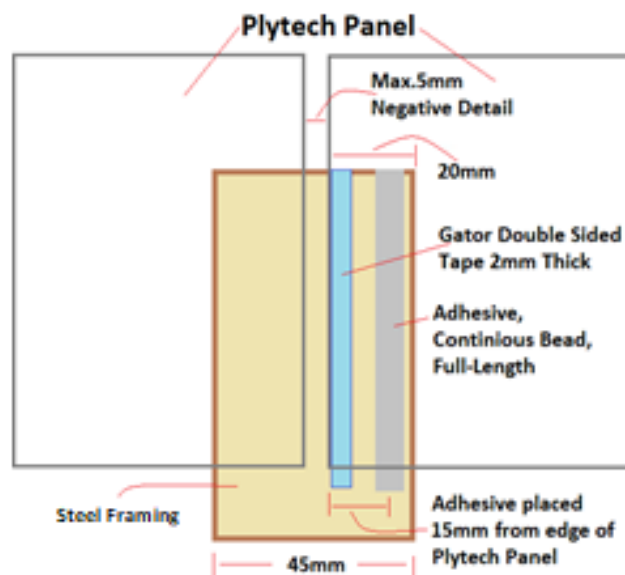

Step 3

Ensure that the “prefinished non-visual side” of the “**Plytech Plywood**” has had the surface wiped down with the Gorilla Solvent Cleaner (especially in the areas where the tape and adhesive will be applied), to remove any construction dusts that may have settled. Leave to dry for a period of 5-10 minutes (longer in colder conditions).

“**All Framing**” (Steel) - the Gorilla Solvent Cleaner needs to be wiped/applied along the full length of these to correspond with the adhesive that will be applied.

Leave to dry for a period of 5-10 minutes (longer in colder conditions).

Step 4

Position the tape, full length onto the battens to one side. This allows room for application of the adhesive (Gorilla 240FC) so that when compressed does not flow over the tape, reducing the potential initial hold of the tape (Gator VHB 2mm Double Sided Foam Tape).

Step 5

Set H-Packers (or aluminum angle support) along the floor to set your predetermined height for the panel from the floor.

Position 7-8mm continuous beads of adhesive the full height/length approx. 20-25mm from the applied tape. When the 7-8mm bead of adhesive is compressed to 2mm thick, it is now approx. 15mm wide.

Step 6

Set & press the plywood panel back into position against the wall. Ensure the panel is set back to the wall, (*the Double-Sided Tape provides the initial bond while the Gorilla 240FC provides the secondary bond*). As the adhesive cures the primary bond is taken by Gorilla 240FC.

Note: As environmental conditions cool, curing times extend for adhesives & sealants.

Step 7

You want to avoid getting the adhesive (Gorilla 240FC) on the edges of the Interior Lining (as the grain finish will make it difficult to remove all residual traces of the adhesive from the edge).

The following points should be noted:

- *Lower temperatures will dramatically increase the time required for the adhesive to cure.* For further guidance on this please contact Soudal Technical.
- Preparation is critical to success

If you have any further questions, please do not hesitate to contact Soudal Ltd: Ph: 08008327732

Option 3. Gypsum Lined Walls

Products Required

- [Gorilla 240FC](#) White 600ml Sausage #20098
- [Holdfast Gator VHB Double Sided Foam Tape](#) 12mm x 2mm x 30m #56665
- [Gorilla Solvent Cleaner](#) (for the back of prefinished plywood panels))
- Clean Cloths for application of cleaner
- [Mr Gorilla Wipes](#) # 46005

Installation Procedure

Step 1

Ensure that you read the Product Technical Documents before you begin. If at that point you have questions, please contact your local Soudal Territory Manager.

Step 2

Ensure that the walls that you are working with are straight and flat, use a straight edge for this. Where this is not so, there may be additional stresses on the bonded joints once applied.

Placement for walls:

1. All Tape/Adhesive Spacing - No greater than 450mm apart.

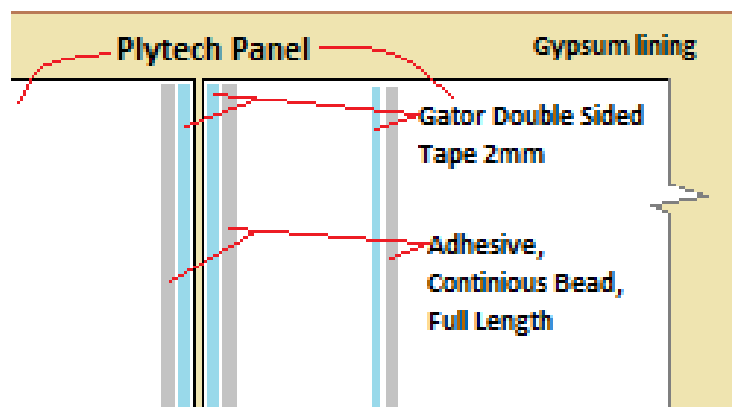

Step 3

It should be noted that all Gypsum walls are to have a full sealer coat over them to stabilise the surface.

If the Gypsum wall has been papered previously, then all paper and glue residues require complete removal. A sealer coat needs to be applied to all surfaces.

If the Gypsum wall has been painted previously, then all surfaces need to be checked to ensure that the paint remains bonded to the wall surface. The painted wall will require complete cleaning to ensure that there are no surface contaminants remaining.

Ensure that the “prefinished non-visual side” of the “**Plytech Plywood**” has had the surface wiped down with the Gorilla Solvent Cleaner (especially in the areas where the tape and adhesive will be applied), to remove any construction dusts that may have settled. Leave to dry for a period of 5-10 minutes (longer in colder conditions).

Leave to dry for a period of 5-10 minutes (longer in colder conditions).

Step 4

Mark out and position the tape, apply full length onto the wall.

Step 5

Set H-Packers (or aluminum angle support) along the floor to set your predetermined height for the panel from the floor.

Position 7-8mm continuous beads of adhesive the full height/length approx. 30mm from the applied tape. This is so that when compressed, the adhesive does not flow over the tape, reducing the potential initial hold of the tape (Gator VHB 2mm Double Sided Foam Tape).

When the 7-8mm bead of adhesive is compressed to 2mm thick, it is now approx. 15mm wide.

Step 6

Set & press the plywood panel back into position against the wall. Ensure the panel is set back to the wall, (*the Double-Sided Tape provides the initial bond while the Gorilla 240FC provides the secondary bond*). As the adhesive cures the primary bond is taken by Gorilla 240FC.

Note: As environmental conditions cool, curing times extend for adhesives & sealants.

Step 7

You want to avoid getting the adhesive (Gorilla 240FC) on the edges of the Interior Lining (as the grain finish will make it difficult to remove all residual traces of the adhesive from the edge).

The following points should be noted:

- *Lower temperatures will dramatically increase the time required for the adhesive to cure.*
For further guidance on this please contact Soudal Technical.
- Preparation is critical to success

If you have any further questions, please do not hesitate to contact Soudal Ltd: Ph: 08008327732